

This copy is provided for convenience only. If necessary, the original may be referred to in the office of the Town Clerk.

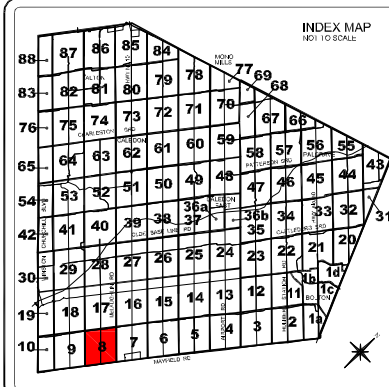
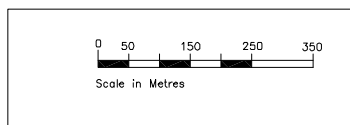

LEGEND

| | |
|--|--------------------------------|
| | A2 ZONE SYMBOL |
| | A2-### ZONE SYMBOL |
| | ZONE BOUNDARY |
| | STRUCTURAL ENVELOPE MAP |

NOTE: Number suffixes represent Exceptions which can be looked up in the Exceptions section of the By-law.

| | |
|---------------------------------------------------------------------------------------------------------------------------------------------------------------------------------------|-----------------------------------------------------------|
| | NIAGARA ESCARPMENT DEVELOPMENT CONTROL AREA |
| Lands lying within the Development Control area pursuant to the Niagara Planning and Development Act are subject to permit requirements under Ontario Regulations 685/80, as amended. | |
| | OAK RIDGES MORAINÉ CONSERVATION PLAN AREA BOUNDARY |
| WELLHEAD PROTECTION AREA BOUNDARY | |
| | WP-2 |
| | WP-5 |
| | WP-10 |
| | WP-25 |
| Zone Maps amended to indicate the 2, 5, 10 and 25 year Wellhead Protection Areas. | |

For applicable zoning see By-law 87-250, as amended.

The base data on this map is provided for convenience only. The Town of Caledon is not responsible for any deficiency or inaccuracy in the base data, and will not accept any liability whatsoever therefor. The reproduction of the base data, in whole or in part, by any means is prohibited without the prior written permission of the Town of Caledon.

BY-LAW 2006-50
ZONE MAP 8
SCHEDULE "A"

TOWN OF CALEDON

| | |
|-------------------------------------|-----------------------|
| DATE: April 3, 2006 | REVISED: Dec. 9, 2008 |
| CREATED BY: D.S. | CHECKED BY: S.M. |
| FILE: Zone Maps 2006-50 and 2007-42 | 8 |