

This copy is provided for convenience only. If necessary, the original may be referred to in the office of the Town Clerk.

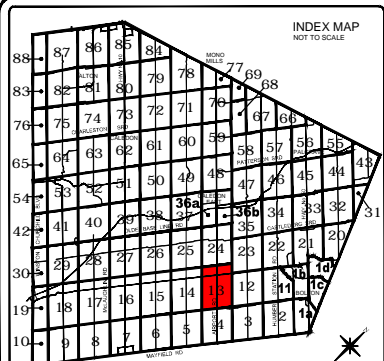

LEGEND

A2	ZONE SYMBOL
A2-###	ZONE SYMBOL NOTE: Number suffixes represent Exceptions which can be looked up in the Exceptions section of the By-law.
—	ZONE BOUNDARY
SE	STRUCTURAL ENVELOPE MAP

	NIAGARA ESCARPMENT DEVELOPMENT CONTROL AREA Lands lying within the Development Control area pursuant to the Niagara Planning and Development Act are subject to permit requirements under Ontario Regulations 685/80, as amended.
	OAK RIDGES MORAINÉ CONSERVATION PLAN AREA BOUNDARY
	WELLHEAD PROTECTION AREA BOUNDARY
	WP-2
	WP-5
	WP-10
	WP-25
Zone Maps amended to indicate the 2, 5, 10 and 25 year Wellhead Protection Areas.	

	For applicable zoning see By-law 87-250, as amended.
	Land subject to Interim Control By-law 2011-093

The base data on this map is provided for convenience only. The Town of Caledon is not responsible for any deficiency or inaccuracy in the base data, and will not accept any liability whatsoever therefor. The reproduction of the base data, in whole or in part, by any means is prohibited without the prior written permission of the Town of Caledon.

BY-LAW 2006-50
ZONE MAP 13
SCHEDULE "A"



Date: April 3, 2006 Revised: August 10, 2011

Provided By: D.S. Checked By: S.M.

File: Zone Maps 2006-50 and 2007-42